

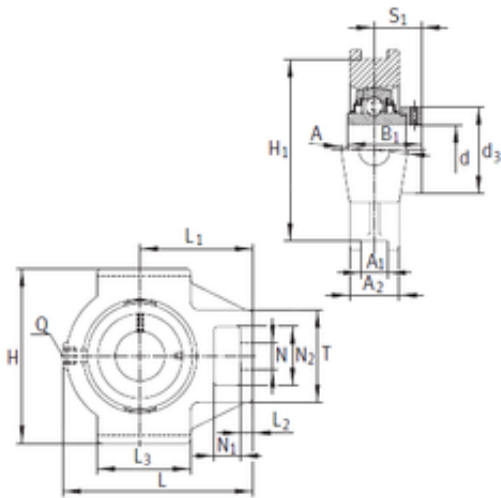

# BEARING OF AMERICA CORP.



RTUE35 Bearing 2D drawings and 3D CAD models

## INA RTUE35 bearing units

Bearing No. RTUE35

Bore Diameter	35 mm
d	35 mm
S1	32,5 mm
Thread (Q)	Rp1/8
L2	13 mm
L3	63 mm
d3	51 mm
A	40 mm
A1	12 mm
B1	51,3 mm
H	102 mm
H1	89 mm
L	131,5 mm
L1	80 mm
N	22 mm
N1	18 mm
T	64 mm
A2	30 mm
N2	36,5 mm
Weight	1,8 Kg
Basic dynamic load rating (C)	25,5 kN
Category	Take Up Unit Bearings
Inventory	0.0
Manufacturer Name	SCHAEFFLER GROUP
Minimum Buy Quantity	N/A
Weight / Kilogram	1.8



## BEARING OF AMERICA CORP.

EAN	4012802068801
Product Group	M06110
Component Description	Take Up Bearing Only
Rolling Element	Ball Bearing
Housing Style	Unit Only
Mounting Method	Eccentric Collar
Compatible Take Up Frame	Not Specified
Adjustment Travel Length	0
Insert Part Number	GE35KRRB
Housing Material	Cast Iron
Other Features	Single Row   Spherical   Double Land Riding Rubber Contact Seal
Inch - Metric	Metric
Long Description	Take Up Bearing Only; 35MM Bore; 12MM Slot Width; 89MM Slot to Slot Distance; Ball Bearing; Unit Only; Eccentric Collar Mount; GE35KRRB Insert Part; Cast Iron Housing Material
Category	Take Up Units
UNSPSC	31171533
Harmonized Tariff Code	8483.20.40.40
Noun	Bearing
Keyword String	Take Up
Manufacturer URL	<a href="http://www.ina.com">http://www.ina.com</a>
Weight / LBS	3.969
Slot Width	0.472 Inch   12 Millimeter
Slot to Slot Distance	3.504 Inch   89 Millimeter
Bore	1.378 Inch   35 Millimeter